

THE STYLE

THE SERVICE

THE SAVOY



SAVOY

SAVOY PARKERS

GYPSY ★★★★★ GYPSY ★★★★★ GYPSY ★★★★★ GYPSY ★★★★★

SAVOY

LOCATED IN THE HEART OF LONDON
WITH UNRIVALLED VIEWS OF THE RIVER THAMES



BE IN THE MIDDLE OF ALL THE ACTION. JUST A FEW STEPS AWAY FROM THE COSMOPOLITAN HUB, COVENT GARDEN

-Located in the West End with over 40 theatres, London Eye, Big Ben, and Trafalgar Square within walking distance.

-Private Pier just a few steps from The Savoy with access to luxury fleet available to host receptions/dinners for up to 450 guests.

-On-Site activities such as mixology contests, butler presentations, and chocolate master classes.

-The Savoy is an ideal base for taking in some culture, with London's vibrant Theatreland, world-class opera houses, museums and galleries all nearby.

-Visit London's most iconic shopping destinations - Covent Garden - Unrivalled in its mix of shops, restaurants, architecture, entertainment and culture, with a range of independent and specialty stores and stylish, contemporary luxury retailers.

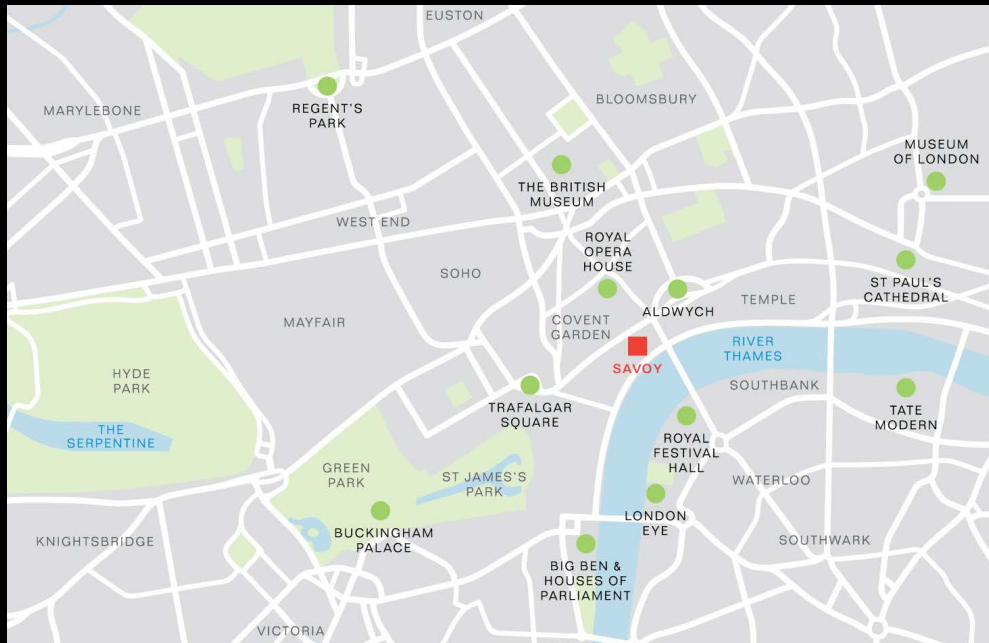

LONDON'S TOP SHOPPING DESTINATION FOR THOSE LOOKING FOR THAT EXTRA PIECE OF LUXURY



The Savoy

My Theatre
London



Information Sir Director, She
Alhambra. Married 1926
Titles include The Lady
Spellbound, Hope etc.
Created Knight Commander
SEE ALSO WIFE'S CARD ITES
Booked by
KRETA

SIR

SAY

Blanes
1950

EXCLUSIVE ADDRESS AND AND UNPARALLELED SERVICE

- 267 spacious rooms and suites.
- Awarded Forbes Travel Guide Five-Star Winner for 2016
- World Famous American Bar awarded World's Best Hotel Bar at Tales of the Cocktail 2011.
- Award Winning Beaufort Bar awarded Best International Bar at Tales of the Cocktail 2015.
- Kaspar's Seafood Bar and Grill voted as London's Best Seafood Restaurant 2016 by Bookatable London.
- Savoy Grill, managed by celebrity Chef Gordon Ramsay, accredited with over seven michelin stars.
- Perfect arrival experience.
- Beauty and Fitness Centre including a pool and 24 hour gym.
- Iconic history- serving the Royal Family, politicians, dignitaries, ambassadors and world renowned celebrities for generations.



A CLASSIC HOTEL, IMMACULATEDLY RESTORED



SUPERIOR QUEEN

Room Size: 30 sq.m / 323 sq.ft.

Bed Type: One Queen bed

View: City or Courtyard View

Total Rooms: 37

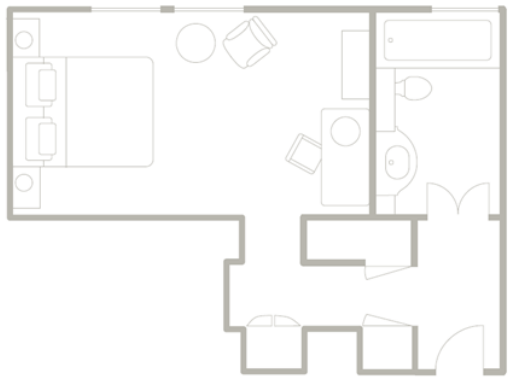

DELUXE KING

Room Size: 35 sq.m / 377 sq.ft.

Bed Type: One King bed

View: City or Courtyard View

Total Rooms:

Deluxe King: 100

Twin options available

Connecting options available

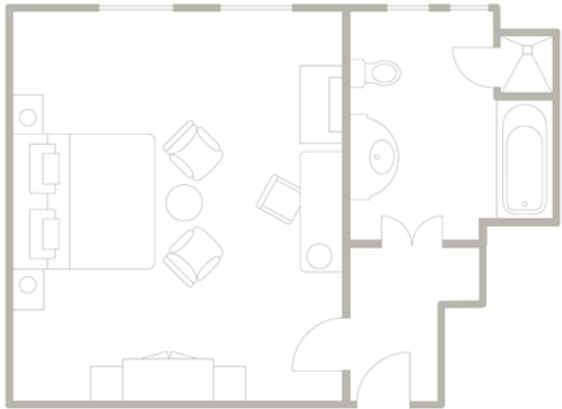

LUXURY KING

Room Size: 40 sq.m / 431 sq.ft.

Bed Type: One King bed or Two Double beds

View: City, Courtyard or Partial River View

Total Rooms: 47

Twin options available (only one room available)

Connecting options available

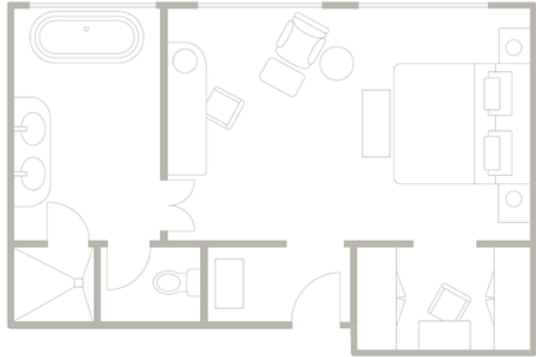

DOUBLE DOUBLE

Room Size: 40 sq.m / 431 sq.ft.

Bed Type: Two Double beds

View: City, Courtyard or Partial
River View

Total Rooms: 6

All possess two beds (which
cannot be unzipped)

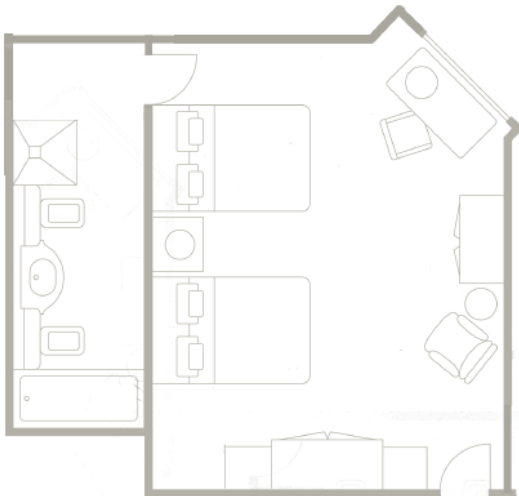

LUXURY KING RIVER VIEW

Room Size: 43 sq.m / 463 sq.ft.

Bed Type: One King bed

View: Direct River View

Total Rooms: 5

Two twin options available



TWO-BEDROOM FAMILY

Room Size: 55 sq.m / 592 sq.ft.

Bed Type: One King bed and Two
Double beds

View: Courtyard View

Total Rooms: 5



JUNIOR SUITE

Room Size: 42 sq.m to 58 sq.m /
452 sq.ft. to 624 sq.ft.

Bed Type: One King bed

View: City or Courtyard View

Total Suites: 14

Connection Options: Deluxe King
room, Double Double and Luxury
King room
117 to 133 sq.m. / 1,260 to 1,432
sq.ft.

Three twin options available

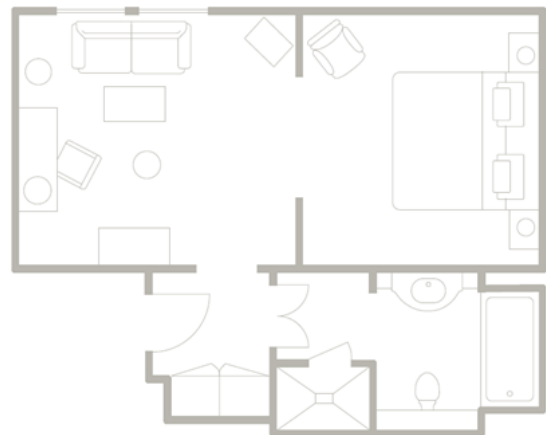

JUNIOR SUITE RIVER VIEW

Room Size: 45 sq.m / 484 sq.ft.

Bed Type: One King bed or Two Twin beds

View: River View

Total Suites: 6

Connection Options: One Bedroom Suite River View
125 sq.m / 1,345 sq. ft.

Or Personality Suite River View
129 sq. m / 1,388W sq. ft.

Three twin options available



JUNIOR SUITE RIVER VIEW BALCONY



DELUXE JUNIOR SUITE

Room Size: 55 sq.m to 68 sq.m / 592 sq.ft. to 732 sq.ft.

Bed Type: One King bed

View: City or Courtyard View

Total Suites: 16

Connection options:

A Superior Queen

85 to 98 sq.m. / 915 to 1,055 sq.ft.

A Junior Suite

97 to 126 sq.m. / 1,044 to 1,356 sq. ft

A One Bedroom Suite

110 to 136 sq.m. / 1,184 to 1,464 sq. ft.

Twin options available



DELUXE JUNIOR SUITE PARTIAL RIVER VIEW

Room Size: 55 sq.m to 68 sq.m / 592 sq.ft. to 732 sq.ft.

Bed Type: One King bed

View: Partial River View

Total Suites: 7

Connection options:

Deluxe Junior Suite
55 sq.m to 68 sq.m / 592 sq.ft. to 732 sq.ft.

Twin options available

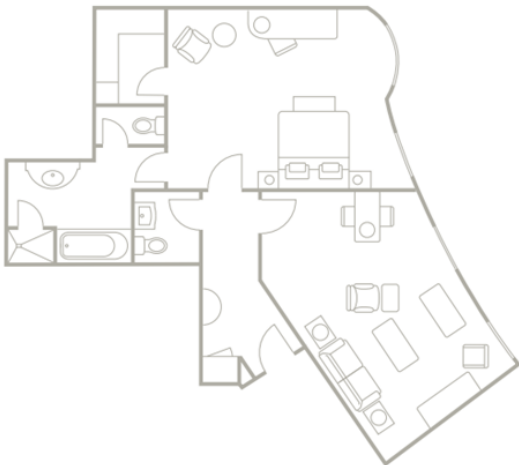

ONE BEDROOM SUITE RIVER VIEW

Room Size: 80 sq.m / 861 sq.ft.

Bed Type: One King bed

View: River View

Total Suites: 14

Connection options: Junior Suite
River View
125 sq.m. / 1,345 sq.ft.

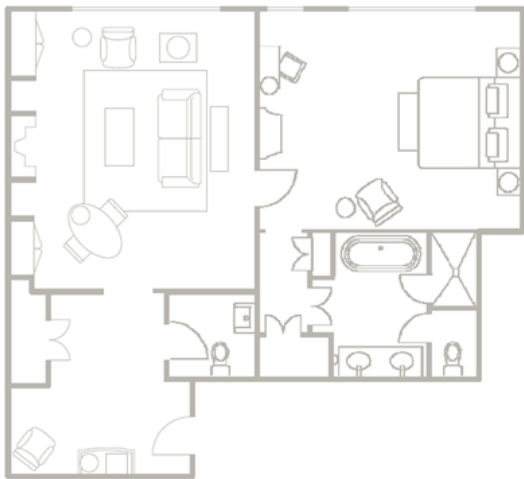

PERSONALITY SUITE PARTIAL RIVER VIEW

Room Size: 68 sq.m to 80 sq.m / 732 sq.ft. to 861 sq.ft.

Bed Type: One King bed

View: Courtyard, City or Partial River View

Total Suites: 3

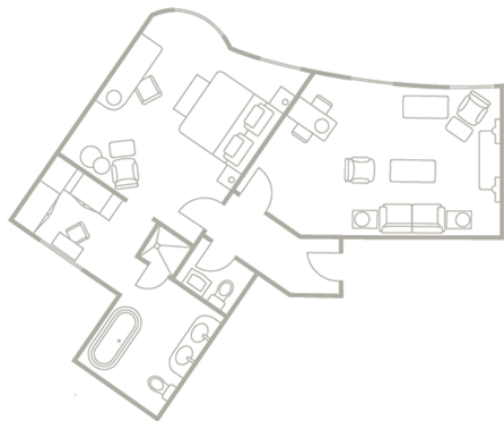

PERSONALITY SUITE RIVER VIEW

Room Size: 84 sq.m / 904 sq.ft.

Bed Type: One King bed

View: Direct River View

Total Suites: 5

Connection options: Junior Suite
River View
129 sq.m. / 1,388 sq.ft.

One twin option available

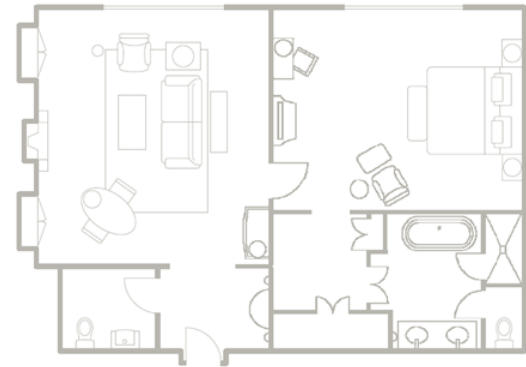

ROYAL SUITE LIVING ROOM



ROYAL SUITE MORNING ROOM



ROYAL SUITE BEDROOM





THE SAVOY SUITE FLOORPLAN



SAVOY

THE SAVOY SUITE LIVING ROOM



THE SAVOY SUITE LIVING ROOM



THE SAVOY SUITE BAR



THE SAVOY SUITE BEDROOM



THE SAVOY SUITE BATHROOM



RIVER ROOM



ABRAHAM LINCOLN ROOM



LANCASTER BALLROOM

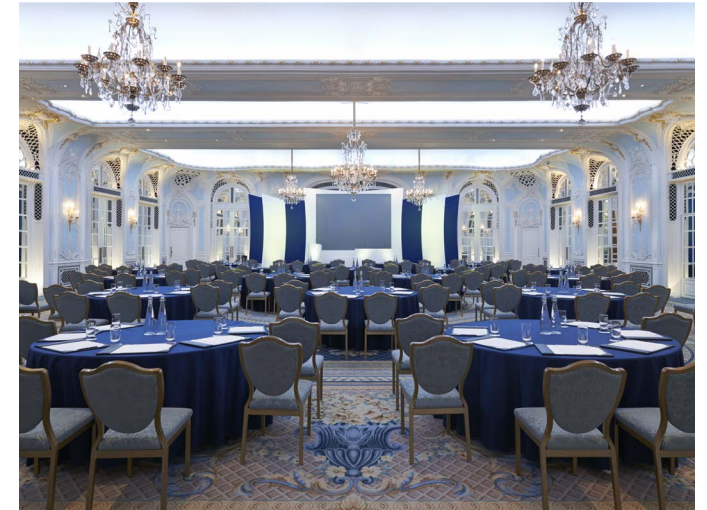

GONDOLIERS ROOM



IOLANTHE ROOM



SORCERER ROOM



PINAFORE ROOM



MIKADO ROOM



PRINCESS IDA AND PATIENCE ROOM



SAVOY TEA

Hand crafted chocolates made by our skilled chocolatiers



THAMES FOYER

Quintessential afternoon tea served within the opulent surroundings of the Thames Foyer



KASPAR'S SEAFOOD BAR AND GRILL

Voted as London's Best Seafood Restaurant 2016 by Bookatable London



SAVOY GRILL

Managed by celebrity Chef Gordon Ramsay, accredited with over seven michelin stars



AWARD WINNING BEAUFORT BAR

Awarded the coveted title of Best International Hotel Bar at Tales of the Cocktail 2015



WORLD FAMOUS AMERICAN BAR

Awarded World's Best International Bar Team at Tales of the Cocktail 2016



SAVOY MUSEUM-AMERICAN BAR

The Moonwalk table located in the exclusive Savoy Museum



BEAUTY AND FITNESS
CENTRE

